

# Step 2: Draw the axes

Make sure to align the N arrow to true north (not magnetic)

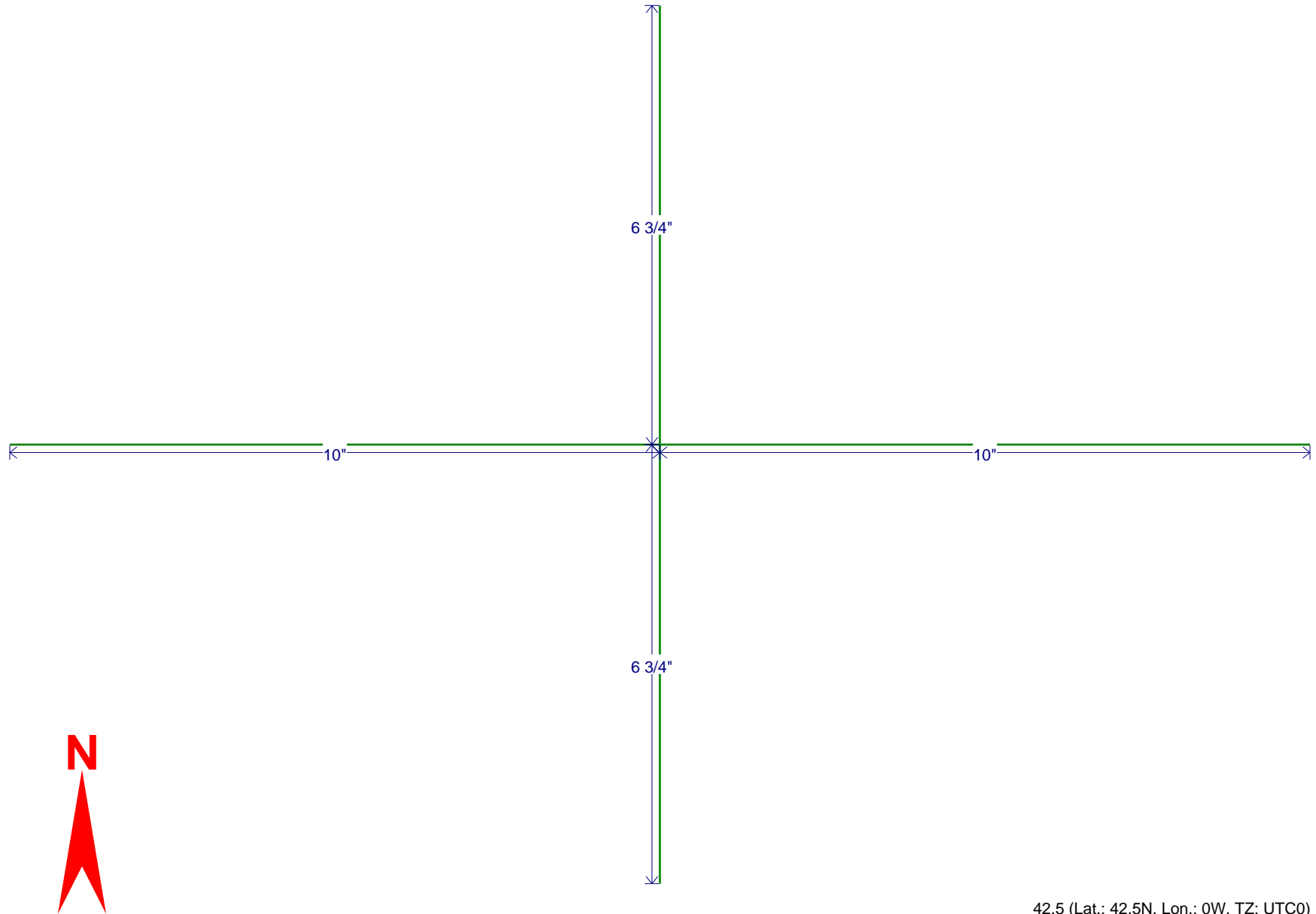

42.5 (Lat.: 42.5N, Lon.: 0W, TZ: UTC0)

# Step 3: Draw the ellipse

Use a loop of length  $34 \frac{3}{4}$ " to draw ellipse.

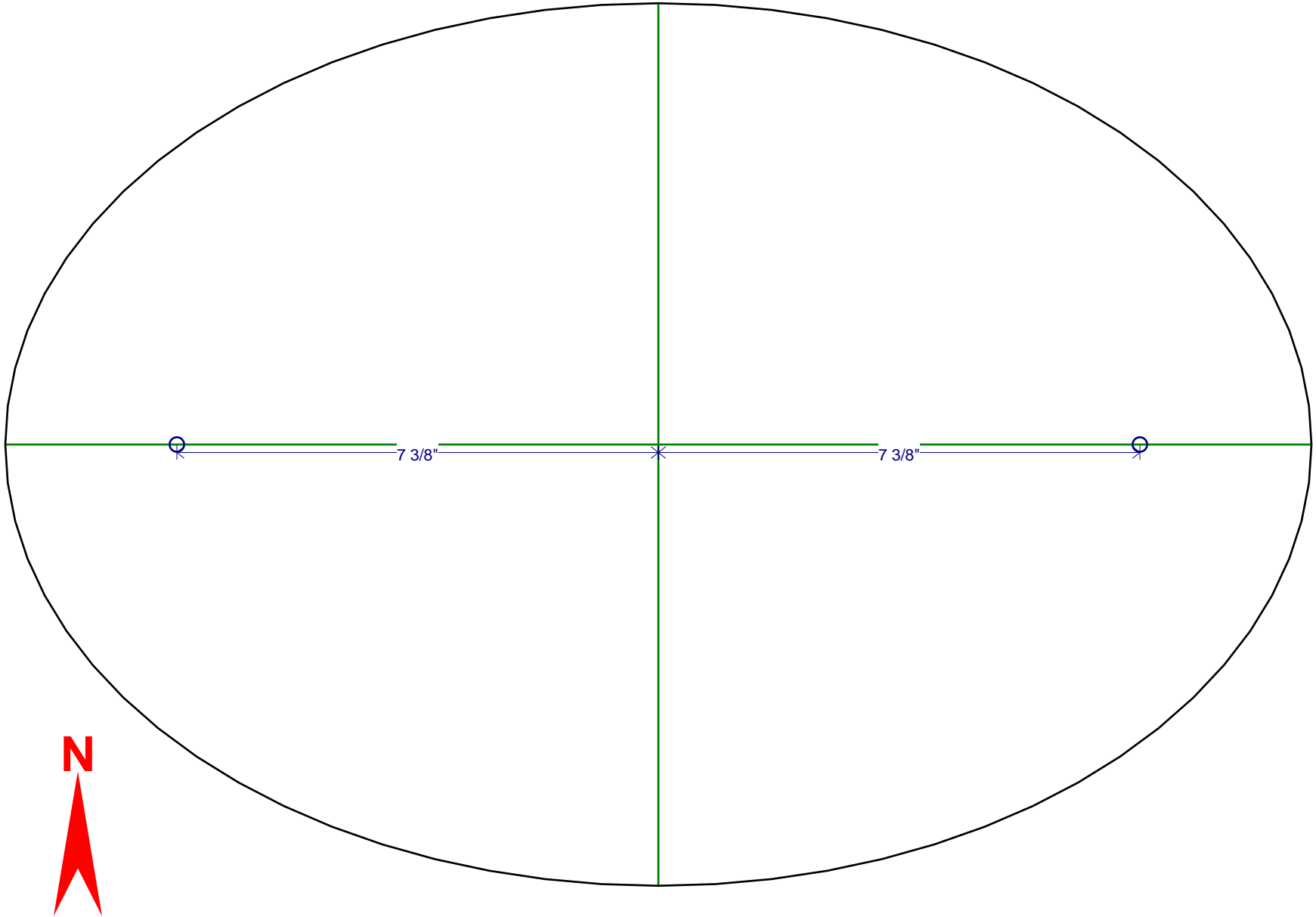

# Step 4a: Draw the hour labels

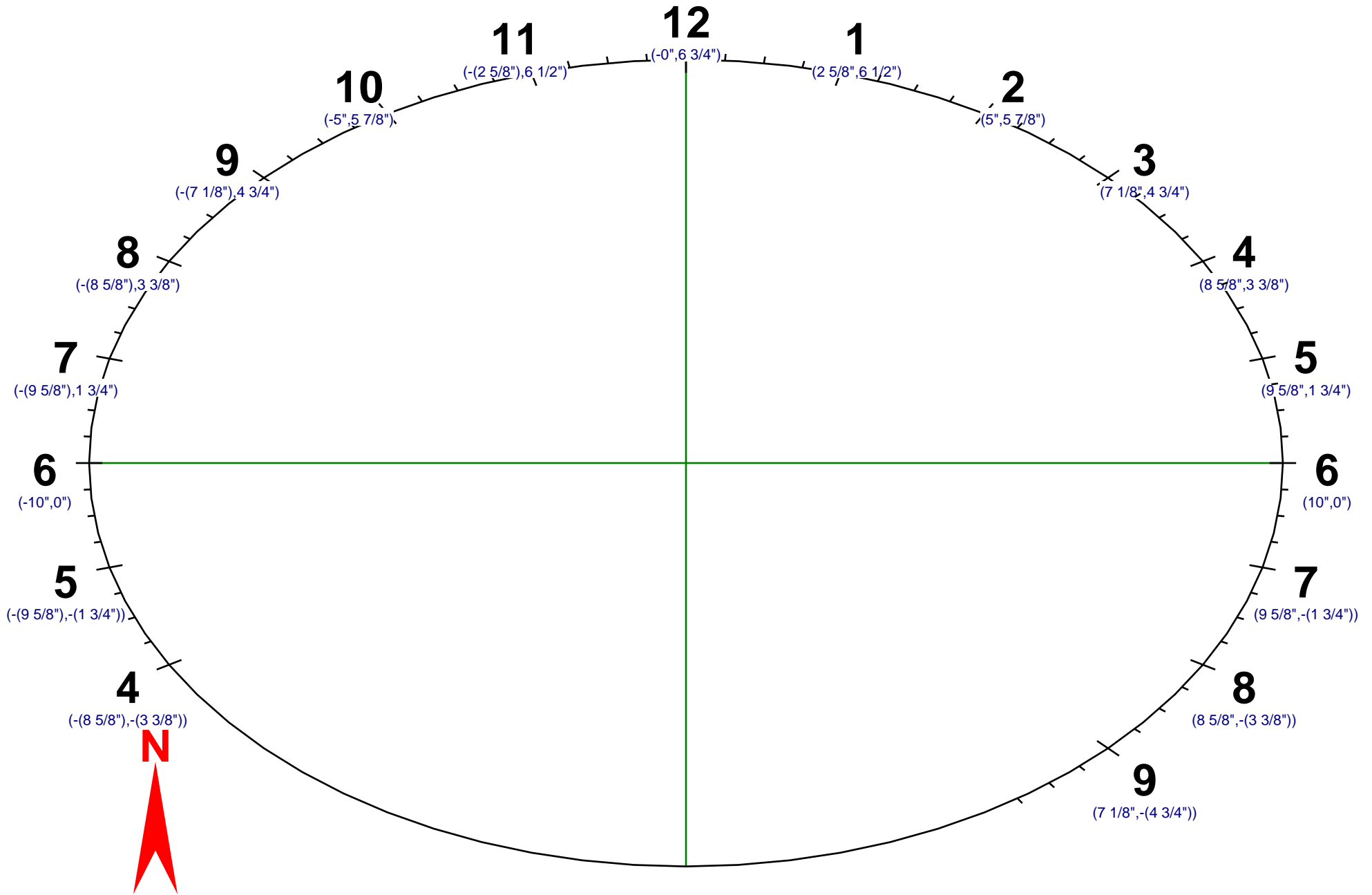

# Step 4b: Verify hour label distances

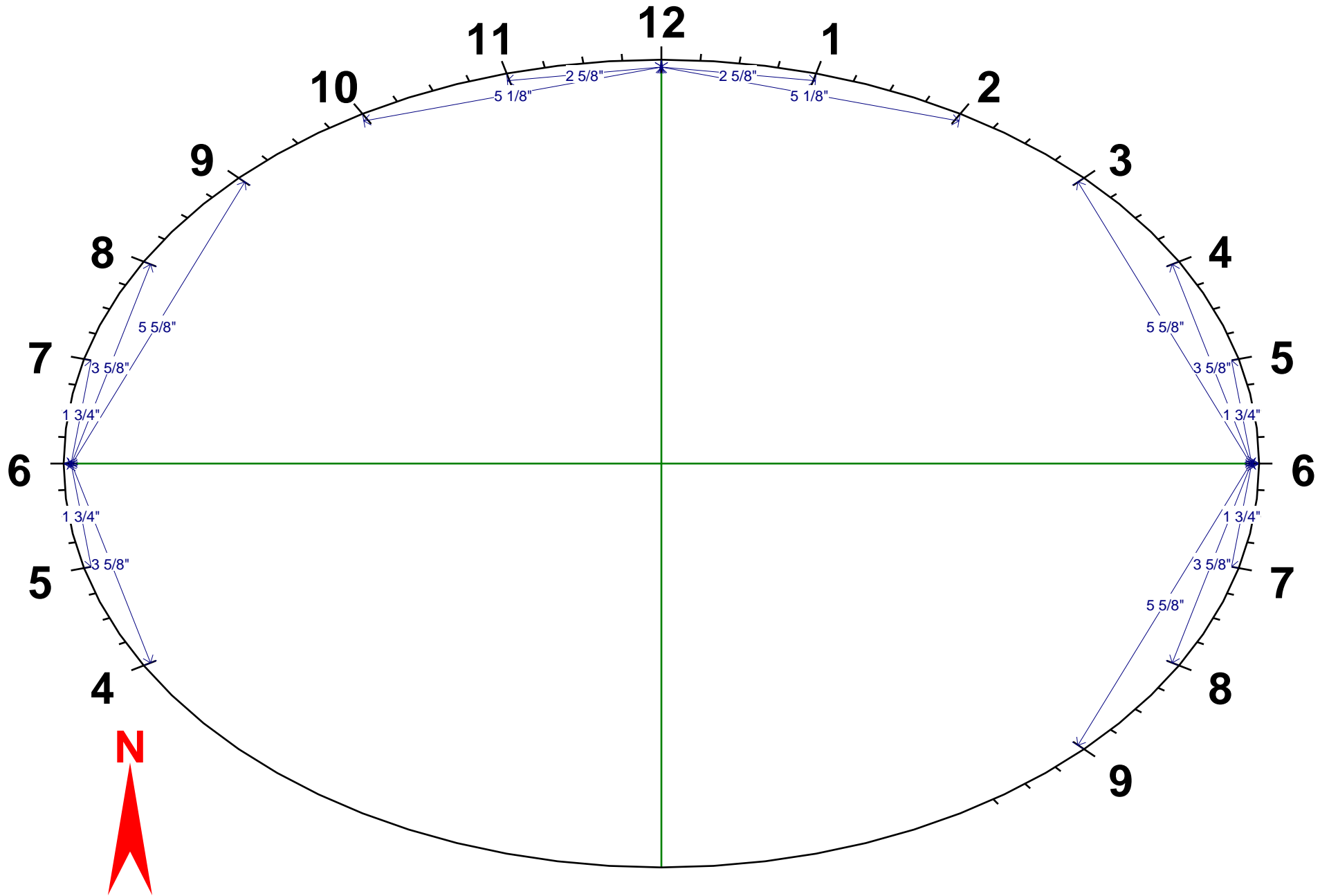

# Step 5: Draw monthly gnomon position tickmarks

Put the tickmarks at the indicated distances from the horizontal line.

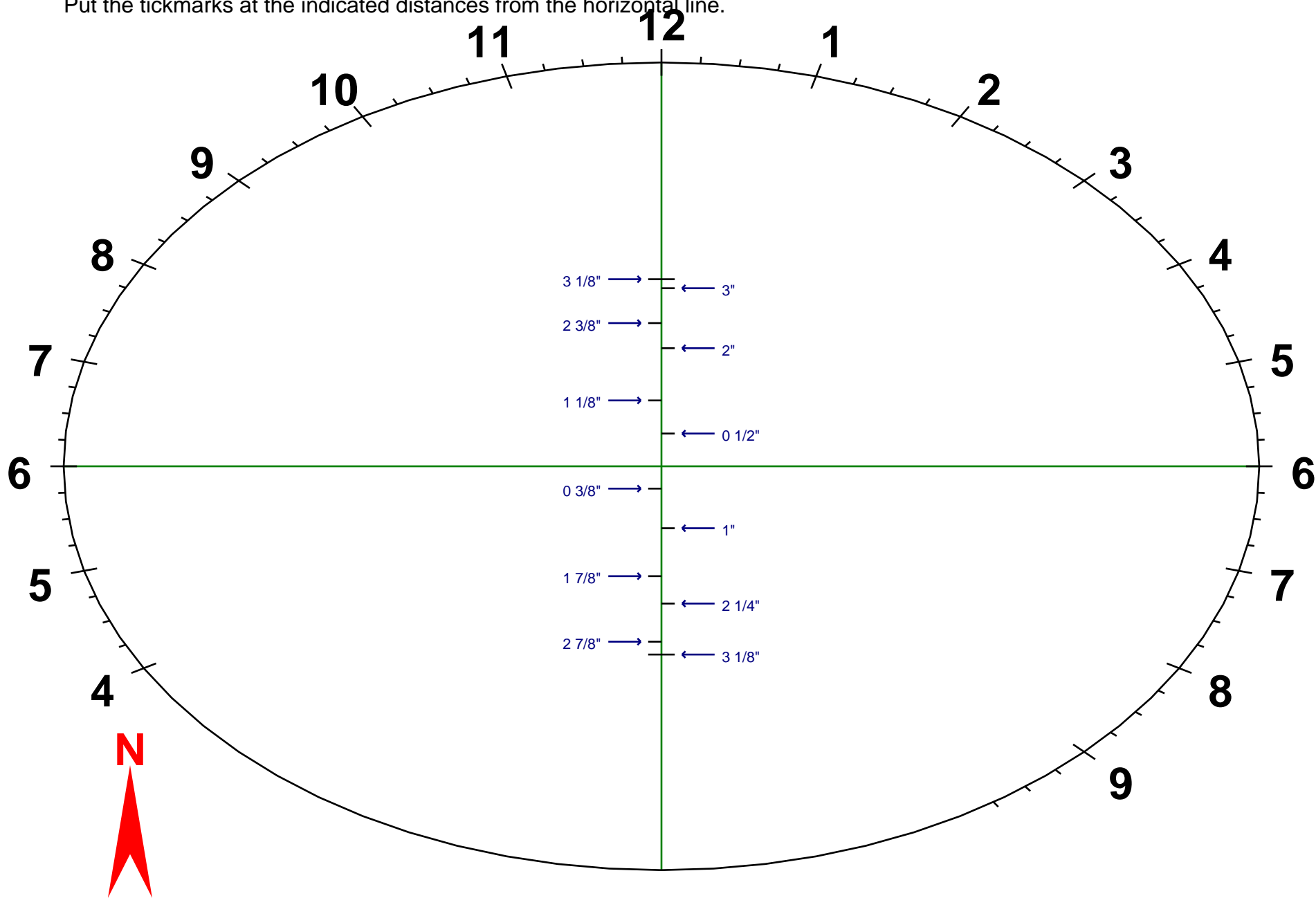

# Step 6: Indicate monthly gnomon positions

Add one hour for summer time

